



## INGREDIENTS

### 6" Block

From white solid fabric, cut: (2) 3" squares, (4) 2" squares, (4) 1½" squares  
From red solid fabric, cut: (2) 3" squares, (5) 1½" squares  
From red print, cut: (4) 2½" squares

### 12" Block

From white solid fabric, cut: (2) 4¾" squares, (4) 3½" squares, (4) 2½" squares  
From red solid fabric, cut: (2) 4¾" squares, (5) 2½" squares  
From red print, cut: (4) 4" square

## INSTRUCTIONS

The following instructions are for the 6" block. The 12" block is made exactly the same way, but the 12" block patch sizes are listed in the brackets [ ].

### Make Split Quarter Square Triangles (Split QSTs)

1. On the wrong side of a white 3" square [4¾" square] use a pencil to lightly draw a diagonal line from corner to corner. Layer the marked white 3" square [4¾" square] atop a solid red 3" square [4¾" square] with right sides together.

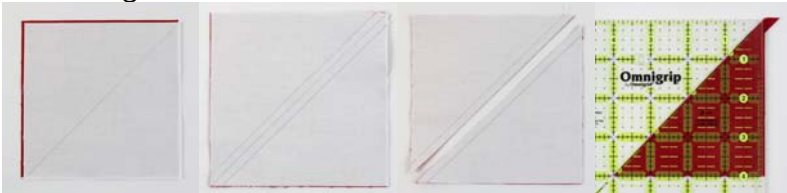

2. Stitch the pair together a scant ¼" from either side of the drawn line. Press to set seams.
3. Cut the unit in half on the drawn line to make 2 half square triangle units ("HSTs").
4. Press the seam allowances toward the red and trim the HST units to measure 2½" x 2½" [4" x 4"] unfinished.
5. On the wrong side of 2 red print 2½" squares [4" squares] use a pencil to lightly draw a diagonal line from corner to corner. Layer the 2 marked red print 2½" squares [4" squares] atop the white/red half square triangle units with right sides together. Make sure that the lines drawn on the red print squares are perpendicular to the seam between the white and red triangles on the HSTs.

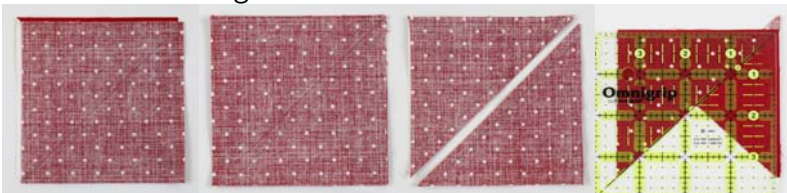

6. Stitch the pairs together a scant ¼" from either side of the drawn line. Press to set seams.
7. Cut the units in half on the drawn lines to make 4 split quarter square triangle units.
8. Press seam allowances toward the red print and trim the 4 split QSTs to 2" x 2" [3½" x 3½"] unfinished. Note that you'll end up with 2 split QSTs that are the mirror of the other 2.

9. Repeat with remaining white and red solid 3" squares [4¾" squares] and red print 2½" squares [4" squares] to make 8 split QSTs—4 with the white in one quarter and 4 with the white in an adjacent, or mirror, quarter.



### Make Checkerboard (9-Patch) Center

1. Lay out 4 white and 5 red solid 1½" squares [2½" squares] in 3 rows of 3 squares each as shown.

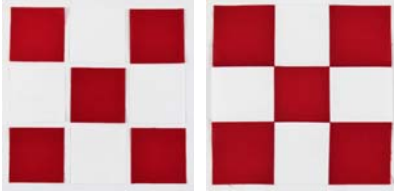

2. Join the pieces in each row, pressing seam allowances toward the red solid. Join the rows together, pressing seam allowances open, to make a checkerboard center measuring 3½" x 3½" [6½" x 6½"] unfinished.

### Assemble Block

1. Join together 1 split QST and 1 mirror split QST as shown to make a split QST pair. Press seam allowances open.



2. Repeat to make 4 split QST pairs.

3. Sew a white 2" square [3½" square] to opposite ends of 2 split QST pairs to make a split QST row. Press seam allowances toward the white square.

4. Lay out 2 split QST rows, checkerboard center, and 2 split QST pairs in 3 rows as shown.

5. Sew a split QST pair to the left and right sides of the checkerboard center. Press seam allowances toward the checkerboard.



6. Sew a split QST row to the top and bottom of the unit from step 5. Press seam allowances toward the checkerboard.



This block finishes at 6" or 12" square.

Jen Daly

{blog: [JenDalyQuilts.com](http://JenDalyQuilts.com)}

{instagram: [jendalyquilts](https://www.instagram.com/jendalyquilts)}

{shop: [Etsy.com/shop/JenDalyQuilts](https://www.etsy.com/shop/JenDalyQuilts)}

{facebook: [jendalyquilts](https://www.facebook.com/jendalyquilts)}

12/3/2018

Original Recipe can be found at [www.modabakeshop.com](http://www.modabakeshop.com)

Recipes are sometimes altered to correct errors. Please ensure that you have downloaded the most recent Printer Friendly Version before starting your project. If you find a mistake in this pattern, please contact [modabakeshop@unitednotions.com](mailto:modabakeshop@unitednotions.com).

This is an original pattern not intended for sale.